

Bullfinch

PERFORMER propane Gas Torch Kit No. 164

Instructions

**Important:- Retain these instructions.
Read them before using the
equipment.**

- Ensure that the rubber sealing washer is in position and that it is undamaged before fitting the Head Connector to the gas cylinder.
- Use only in a well ventilated area.
- Operate away from flammable materials.
- Secure burner to the Head Connector with 11 mm spanner, do not use excessive force.
- Screw Head Connector to gas cylinder hand tight.
- Check for leaks with a leak detecting fluid or a suitable soap solution. Rectify all leaks before using.
- To light. Open valve and apply ignition flame to burner.
- To turn off. Close valve (clockwise).
- Remove Head Connector from cylinder for storage.

- **Warning:-** Burner gets hot when in use.
- Use only disposable propane or MAPP® gas cylinders with a CGA 600 connection (see diagram).

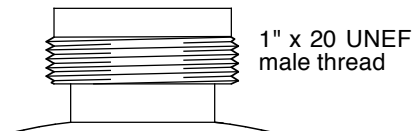

- Never attempt to modify the equipment.
- For service replacements use only approved Bullfinch spare parts.

Accessories

No. 1650
Pencil Burner 20g/h 

No. 1651
Fine Flame
Burner 60g/h 

No. 1652
Regular Burner
160 g/h 

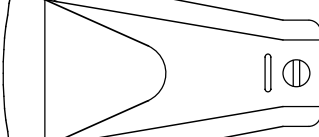
No. 1474
Fishtail
Attachement
(fits No. 1652
Burner) 

Spare Parts

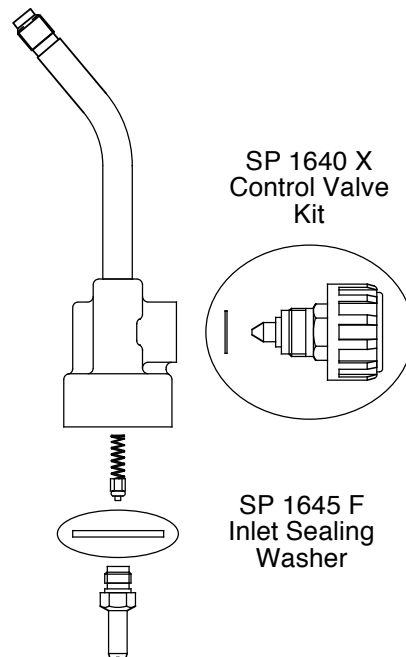

Bullfinch (Gas Equipment) Limited
Diadem Works, Kings Road, Tyseley, Birmingham B11 2AJ England.
Tel: 0121 706 6301 (Int. +44 121 706 6301)
Fax: 0121 707 0995 (Int. +44 121 707 0995)
e-mail: sales@bullfinch-gas.co.uk
web: www.bullfinch-gas.co.uk