

Secure the hose clips as shown in the diagram.

We cannot recommend a particular size of clip for hose with a given size since the outside diameter can vary considerably.

To replace the reflector

Remove the air baffle from the pilot assembly to expose hexagon.

Open front of lamp by unscrewing the knob on the side of the housing

Remove locknut from pilot burner, withdraw reflector from lamp.

Reassemble in reverse order. Ensure that air baffle slot is facing down.

To replace the spark electrode

Remove the reflector as described in 4.6.

Disconnect igniter lead.

Remove electrode securing screw and withdraw electrode.

Reassemble in reverse order.

To replace the binary lens

Open front of lamp by unscrewing the knob on the side of the housing.

Loosen the spring clip screws and remove existing lens, if lens is broken,

handle glass with care. Remove any dirt or grit from around the lens

seat.

Fit new binary lens and tighten the retaining clip screws. It is important

that each lens half is not forced into place and once in position there

should be free movement, up and down and from side to side.

SPARE PARTS See diagram

Part	Description	No. Part	Description
1041	Regulator	10 SP1595W	Retaining Clip Kit
SP1235L	Gas Valve Assembly	11 SP1235AE	Hose & Regulator
SP1235AF	Electrode Assembly	12 1223	Universal Clamp
SP A	Jet No. A	13 SP 1225W	Wheel Knob
SP D	Jet No. D	14 1299	4,8 Bore H.P. Hose (0,5m)
SP1235E	Reflector	15 1324	'O' Clip (11-13mm)
1228	Mantle	15 1326	'O' Clip (13-15mm) Alternative
SP 1225BC	Steatite Nozzle		
1224	Binary Lens (Available in pairs only)		

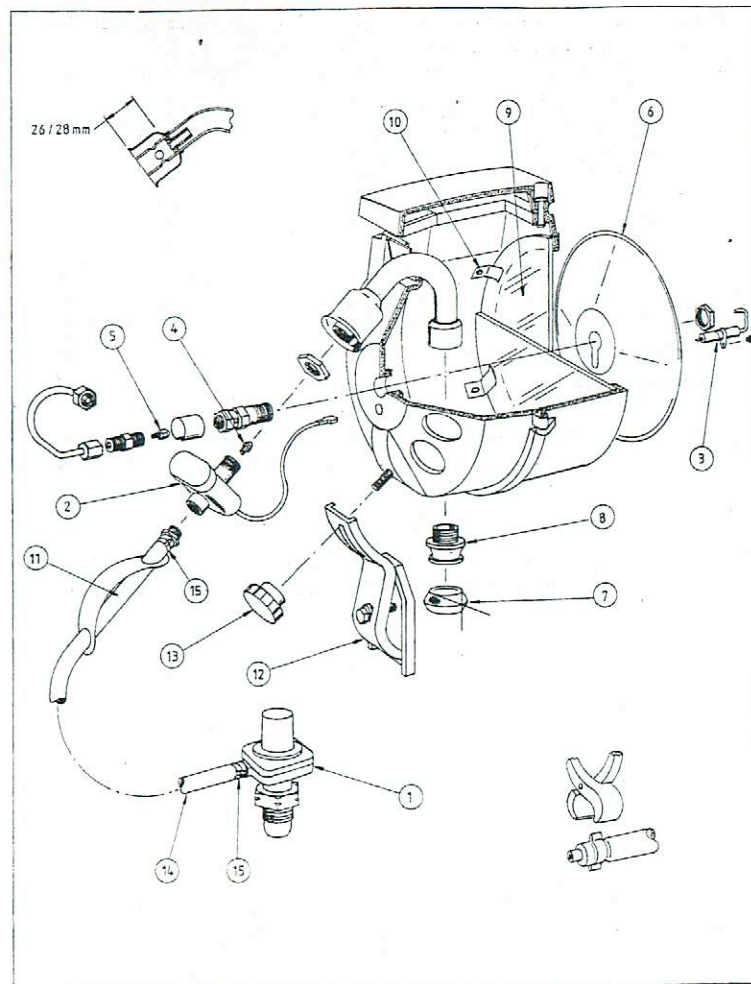

Bullfinch (Gas Equipment) Limited
 Diadem Works, Kings Road, Tyseley, Birmingham B11 2AJ.
 Telephone: 0121 706 6301 Fax. 0121 707 0995
 1235 AU Iss 1



BULLFINCH AUTO-MINIFLOOD No. 1235

A non-domestic, portable floodlight for propane gas. Piezo-electric ignition.
 For Propane at 1 bar.

SERVICING AND MAINTENANCE INSTRUCTIONS

CONTENTS

Section No.

- 1 Introduction
- 2 Technical Data
- 3 Maintenance
- 4 Servicing
- 5 Spare Parts

INTRODUCTION

The Bullfinch Auto-Miniflood model No. 1235 is a portable non-domestic floodlight with piezo-electric spark ignition using propane at 1 bar (14,5 psi) .

The lamp is supplied already assembled with hose and regulator and has a universal clamp for mounting to a gas cylinder, this clamp allows for tilt adjustment of the lamp. Auto-Miniflood lamps have been tested and certified in accordance with the Gas Appliance (Safety) Regulations 1992.

TECHNICAL DATA

Heat input	0,672 kW (2293 Btu/h)
Gas consumption	57 g/h (30,3 dm ³ /h)
Gas pressure	1 bar (14,5 p.s.i.)
Jet sizes	Main A Pilot D
Weight	2,4 kg (1,06 lb)
Dimensions (width)	240 mm (9,5 in)
(height)	350 mm (13,8 in)
(depth)	240 mm (9,5 in)
Gas connection	Pressure regulator to BS 3016 5/8 BSP-14-LH-E- POL.

data are approximate and, in line with our product improvement policy, may be subject to revision without notice.

ROUTINE MAINTENANCE

The following routine maintenance checks should be carried out if the lamp has not been used for some time. If the lamp is in regular use more frequent inspections may be required.

Cleaning

The metal surfaces and the binary lens can be wiped, when cold, with a damp cloth. Avoid touching the mantle, it is very fragile. Occasionally, especially if the lamp has not been used for some time, unscrew the ceramic nozzle and with a high pressure airline blow through the gas mixing tube to clear any dust or insect debris that may have lodged there.

Mantle Replacement

The mantle should be replaced if it develops splits or holes.

- 1 Open the front of the lamp by unscrewing the knob on the side of the housing and remove the remains of the old mantle and any ash inside the lamp. Take care not to breathe in the dust, wrap the remains of the old mantle in paper and place in garbage disposal. If the ceramic nozzle is cracked or broken replace it with a new one.

- 2 Place the open end of the new mantle over the lip of the nozzle; pull the drawstring tight, knot it and cut off any excess string.

- 3 Distribute the fabric evenly and if lamp is to used immediately, burn off the mantle as described in the Operating Instructions.

Note: Always wash hands with soap and water or wet wipes, after handling mantles.

3.3 Hose

The hose should be inspected at regular intervals and checked for damage. If it is cut, split or damaged it should be replaced with a maximum 0,5 m of 4,8 mm bore high pressure hose to BS 3212/2 (Bullfinch No. 1299).

3.3 Controls

Check that the piezo-igniter functions normally and creates a spark at the electrode, the spark gap should be between 4 - 4,5 mm. the pilot burner ignites from the spark and the pilot should only remain lit whilst the igniter button is depressed.

3.4 Operation

Light the lamp in accordance with the Operating Instructions and ensure that the lamp is burning with a brilliant even light, but avoid looking directly at the mantle as its brightness may temporarily affect your vision.

3.5 Gas Soundness

Check the gas soundness of all the joints with a leak detecting fluid (Bullfinch No. 550 is suitable) and rectify any leaks before using the lamp.

Never search for gas leaks with a naked flame.

4. SERVICING

Servicing should only be carried out by trained and competent service agents. After the servicing or replacement of any part check for gas leaks and correct operation.

4.1 Gas Jets To clean or replace the gas jets (sizes A and D)

The Auto-Miniflood uses two gas jets; a main jet (size A) controlling the gas to the mantle and a pilot jet (size D).

4.1.1 Main Jet

- 1 Disconnect the pilot supply tube from the gas valve and pilot assembly.
- 2 Remove the ignition lead from the spark electrode.
- 3 Slacken the locknut above the gas valve using a thin 9/16 in BSW spanner and unscrew the gas valve complete with hose and regulator from the gas mixing tube.
- 4 Remove the jet and clean or renew.
- 5 Use PTFE tape or a small amount of sealing compound on the jet threads and replace the jet into the gas valve.
- 6 Reassemble in reverse order.

4.1.2 Pilot Jet

- 1 Disconnect the pilot supply tube from the gas valve and pilot assembly.
 - 2 Remove air baffle from the pilot assembly.
 - 3 Unscrew the pilot jet adaptor from the pilot burner.
 - 4 Remove the jet and clean or renew.
 - 5 Use PTFE tape or a small amount of sealing compound on the jet threads and replace the jet into the adaptor.
 - 6 Reassemble in reverse order. Position the air baffle with the split to the underside of the pilot burner in order to protect the jet from rain.
- Note: Jets should only be cleaned with a solvent or compressed air. If they cannot be cleaned easily they should be renewed. Never poke out a jet orifice; it will damage the jet and effect the safety and performance of the lamp.

4.2 Gas Valve To replace the gas valve

- 1 remove the pilot supply tube from the gas valve and pilot assembly.
- 2 Remove the ignition lead from the spark electrode.
- 3 Unscrew the regulator and hose assembly from the gas valve.
- 4 Slacken the locknut above the gas valve using a thin 9/16 in BSW spanner and unscrew the gas valve from the gas mixing tube.
- 5 Apply PTFE tape to the male taper thread of the hose assembly adaptor, fit new gas valve and reassemble in reverse order.

4.3 Hose and regulator Assembly To replace the hose and regulator assy.

- 1 Unscrew the regulator and hose assembly from the gas valve.
- 2 Apply PTFE tape to the male taper thread of the hose assembly adaptor and fit to gas valve.

4.4 Regulator To replace regulator

- 1 Unscrew the regulator and hose assembly from the gas valve.
- 2 Cut through the hose approx. 50 mm from the regulator and discard the regulator, ensure that the warning label is attached to the hose.
- 3 Place a hose clip over the free end of the hose and push the end of the hose over the nozzle of the new regulator and secure the hose clip as shown in the diagram.

Note: It is dangerous to attempt to adjust or repair the regulator. We cannot recommend a particular size of clip for hose with a given bore size since the outside diameter can vary considerably.

4.5 Hose To replace hose

- 1 Unscrew hose and regulator assembly from the gas valve.
- 2 Remove and discard the existing hose clips and cut away the hose from the regulator and the threaded hose connector. Avoid damage to the ribbed hose connections.
- 3 Recover the warning label attached to the existing hose.
- 4 Slip warning label and new hose clips over both ends of the new hose and push the ends over the hose connector and regulator connections. The hose should be a tight fit.